

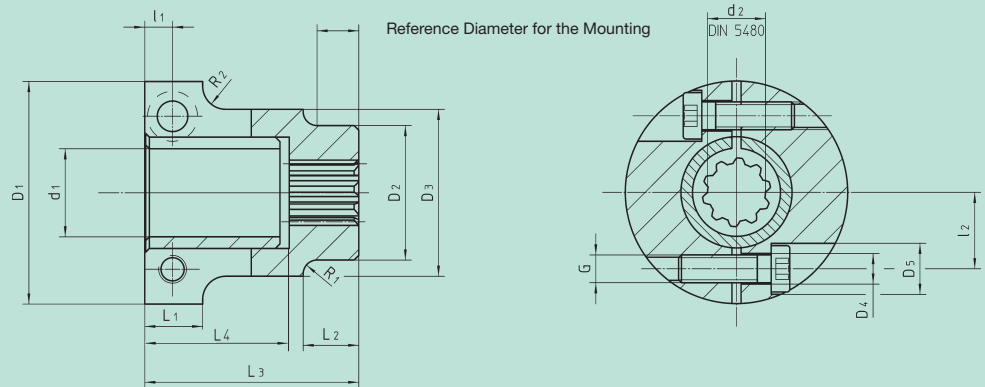

### Special Couplings for Motor/Gear Units, Rigid Model, nitrided, preassembled for Motor Shafts without Key

Bore on gear unit side  
low-clearance tooth-hub  
profile corresponding to  
DIN 5480 for push-fitting



#### Order Code

Coupling	d <sub>1</sub>	d <sub>2</sub>	D <sub>1</sub>	D <sub>2</sub>	D <sub>3</sub>	D <sub>4</sub>	D <sub>5</sub>	l <sub>1</sub>	l <sub>2</sub>	L <sub>1</sub>	L <sub>2</sub>	L <sub>3</sub>	R <sub>1</sub>	R <sub>2</sub>	G	L <sub>4</sub>	J <sub>red</sub> 10 <sup>-4</sup> kg m <sup>2</sup>	kg
65 51 008	8	15x1.25x10	36	23	-	5.5	9.0	7.5	13.0	14.0	-	46.0	5	-	M5	31.2	0.236	0.2
65 51 009	9	15x1.25x10	36	23	-	5.5	9.0	7.5	13.0	14.0	-	46.0	5	-	M5	31.2	0.246	0.2
65 51 010	10	15x1.25x10	36	23	-	5.5	9.0	7.5	13.0	14.0	-	46.0	5	-	M5	31.2	0.244	0.2
65 51 011	11	15x1.25x10	36	23	-	5.5	9.0	7.5	13.0	14.0	-	46.0	5	-	M5	31.2	0.243	0.2
65 51 014	14	15x1.25x10	36	23	-	5.5	9.0	7.5	13.0	14.0	-	46.0	5	-	M5	31.2	0.234	0.2
65 51 016	16	15x1.25x10	36	23	-	5.5	9.0	7.5	13.0	14.0	-	46.0	5	-	M5	31.2	0.225	0.2
65 53 019	19	15x1.25x10	48	33	36	6.6	11.0	8.0	16.5	16.5	9	46.0	5	3	M5	31.2	0.704	0.3
65 53 022	22	15x1.25x10	48	33	36	6.6	11.0	8.0	16.5	16.5	9	46.0	5	3	M5	31.2	0.704	0.3
65 53 024	24	15x1.25x10	48	33	36	6.6	11.0	8.0	16.5	16.5	9	46.0	5	3	M5	31.2	0.647	0.2
65 53 025	25	15x1.25x10	78	51	-	9.0	15.0	9.0	29.0	18.0	-	55.5	5	-	M8	41.5	5.946	1.1
65 53 028	28	15x1.25x10	78	51	-	9.0	15.0	9.0	29.0	18.0	-	55.5	5	-	M8	41.5	5.871	1.1
65 53 032	32	15x1.25x10	64	51	-	9.0	15.0	9.0	24.0	18.0	-	55.5	5	-	M8	41.5	4.158	0.8
65 53 035	35	15x1.25x10	78	51	-	9.0	15.0	9.0	29.0	18.0	-	55.5	5	-	M8	41.5	5.605	1.0
65 53 038	38	15x1.25x10	78	51	-	9.0	15.0	9.0	29.0	18.0	-	55.5	5	-	M8	41.5	5.432	0.9
65 54 009	9	25x1.25x18	49	35	-	6.6	11.0	8.5	18.0	17.0	-	68.0	5	-	M6	43.5	2.306	0.5
65 54 010	10	25x1.25x18	49	35	-	6.6	11.0	8.5	18.0	17.0	-	68.0	5	-	M6	43.5	2.300	0.5
65 54 011	11	25x1.25x18	49	35	-	6.6	11.0	8.5	18.0	17.0	-	68.0	5	-	M6	43.5	2.381	0.5
65 54 014	14	25x1.25x18	49	35	-	6.6	11.0	8.5	18.0	17.0	-	68.0	5	-	M6	43.5	1.161	0.5
65 54 015	15	25x1.25x18	49	35	-	6.6	11.0	8.5	18.0	17.0	-	68.0	5	-	M6	43.5	2.328	0.5
65 54 016	16	25x1.25x18	49	35	-	6.6	11.0	8.5	18.0	17.0	-	68.0	5	-	M6	43.5	1.161	0.5
65 54 019	19	25x1.25x18	49	35	-	6.6	11.0	8.5	18.0	17.0	-	68.0	5	-	M6	43.5	1.112	0.4
65 54 020	20	25x1.25x18	49	35	-	6.6	11.0	8.5	18.0	17.0	-	68.0	5	-	M6	43.5	2.268	0.5
65 54 022	22	25x1.25x18	49	35	-	6.6	11.0	8.5	18.0	17.0	-	68.0	5	-	M6	43.5	2.179	0.4
65 54 024	24	25x1.25x18	49	35	-	6.6	11.0	8.5	18.0	17.0	-	68.0	5	-	M6	43.5	1.007	0.4
65 54 025	25	25x1.25x18	78	51	-	9.0	15.0	9.0	29.0	18.0	-	68.0	5	-	M8	43.5	8.165	1.2
65 54 028	28	25x1.25x18	78	51	-	9.0	15.0	9.0	29.0	18.0	-	68.0	5	-	M8	43.5	8.061	1.2
65 54 032	32	25x1.25x18	78	51	-	9.0	15.0	9.0	29.0	18.0	-	68.0	5	-	M8	43.5	7.751	1.2
65 54 035	35	25x1.25x18	78	51	-	9.0	15.0	9.0	29.0	18.0	-	68.0	5	-	M8	43.5	7.690	1.1
65 54 038	38	25x1.25x18	78	51	-	9.0	15.0	9.0	29.0	18.0	-	68.0	5	-	M8	43.5	7.348	1.1
65 54 042	42	25x1.25x18	78	51	-	9.0	15.0	9.0	29.0	18.0	-	65.5	5	-	M8	43.5	6.595	1.1
65 55 014	14	38x1.25x29	78	51	-	9.0	15.0	9.0	29.0	18.0	-	72.5	5	-	M8	41.5	8.056	1.2
65 55 016	16	38x1.25x29	78	51	-	9.0	15.0	9.0	29.0	18.0	-	72.5	5	-	M8	41.5	8.029	1.2
65 55 019	19	38x1.25x29	78	51	-	9.0	15.0	9.0	29.0	18.0	-	72.5	5	-	M8	41.5	7.978	1.2
65 55 020	20	38x1.25x29	78	51	-	9.0	15.0	9.0	29.0	18.0	-	72.5	5	-	M8	41.5	7.945	1.2
65 55 022	22	38x1.25x29	78	51	-	9.0	15.0	9.0	29.0	18.0	-	72.5	5	-	M8	41.5	7.911	1.2
65 55 024	24	38x1.25x29	78	51	-	9.0	15.0	9.0	29.0	18.0	-	72.5	5	-	M8	41.5	7.860	1.2
65 55 025	25	38x1.25x29	78	51	-	9.0	15.0	9.0	29.0	18.0	-	72.5	5	-	M8	41.5	7.818	1.1
65 55 028	28	38x1.25x29	78	51	-	9.0	15.0	9.0	29.0	18.0	-	72.5	5	-	M8	41.5	8.105	1.3
65 55 032	32	38x1.25x29	78	51	-	9.0	15.0	9.0	29.0	18.0	-	72.5	5	-	M8	41.5	7.863	1.2
65 55 035	35	38x1.25x29	78	51	-	9.0	15.0	9.0	29.0	18.0	-	72.5	5	-	M8	41.5	7.610	1.1
65 55 038	38	38x1.25x29	78	51	-	9.0	15.0	9.0	29.0	18.0	-	72.5	5	-	M8	41.5	7.284	1.0
65 55 042	42	38x1.25x29	78	51	-	9.0	15.0	9.0	29.0	18.0	-	70.5	5	-	M8	41.5	6.547	1.0

Couplings on page GA-10 can be used as well.



### Shrink-Disk Clamping Sets for Output Drive Shafts of Gear Series 59 1. ...

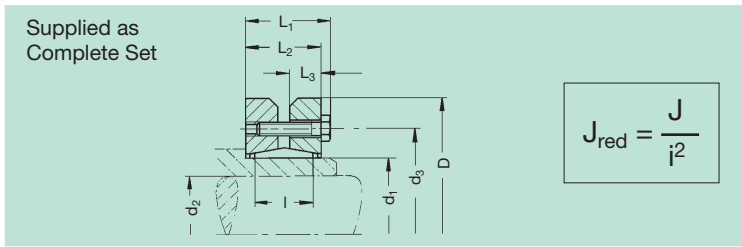

Order Code	a <sub>0</sub> mm	T <sub>2max</sub> Nm	d <sub>1</sub>	d <sub>2</sub>	d <sub>3</sub>	D	L <sub>1</sub>	L <sub>2</sub>	L <sub>3</sub>	I	G	Torque	J 10 <sup>-4</sup> kg m <sup>2</sup>	kg
80 81 024	32	270	24	20	36	50.2	23.4	19.40	7.6	14	6 x M5	5 Nm	0.780	0.2
80 83 130	50	280	30	25	44	60.2	25.0	21.50	9.0	18	7 x M5	4 Nm	1.756	0.3
80 84 136	63	430	36	28	52	72.2	27.5	23.50	10.0	22	5 x M6	12 Nm	4.029	0.4
80 85 150	80	950	50	36	72	90.2	31.5	27.54	12.0	22	9 x M6	12 Nm	11.322	0.8
80 86 062	100	2300	62	48	89	110.2	34.5	30.50	13.0	22	10 x M6	12 Nm	27.137	1.3