

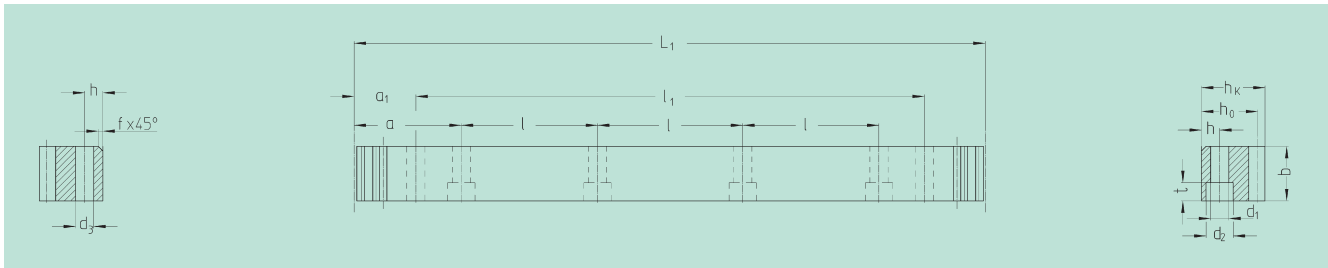

### Quality 8



Order Code	Module	L <sub>1</sub>	N° of Teeth	b	h <sub>k</sub>	h <sub>0</sub>	f	a	l	N° of Holes	h	d <sub>1</sub>	d <sub>2</sub>	t	a <sub>1</sub>	l <sub>1</sub>	d <sub>3</sub>	kg
34 20 108	2	1005.3	160	25	24	22	2	62.8	125.66	8	8	7	11	7	31.3	942.7	5.7	4.2
34 30 108	3	1017.9	108	30	29	26	2	63.6	127.23	8	9	10	15	9	34.4	949.1	7.7	6.0
34 40 108	4	1005.3	80	40	39	35	2	62.8	125.66	8	12	14	20	13	37.5	930.3	11.7	10.5
34 50 108	5	1005.3	64	50	39	34	2.5	62.8	125.66	8	12	14	20	13	30.2	945.0	11.7	13.4

Total pitch error  $GT_f/1000 \leq 0.060$  mm.

- Teeth induction-hardened and ground
- Material C45
- Bright steel, profile blasted

Mounting racks see page ZF-2.

To achieve precision rack joints, we recommend our patented rack assembly kit, see page ZF-4.

For lubrication of rack & pinions we recommend our automatic lubrication systems, see page ZE-1.

For the calculation and selection of the rack & pinion drive, see page ZD-1.

Screws for rack mounting, see page ZF-3.

