

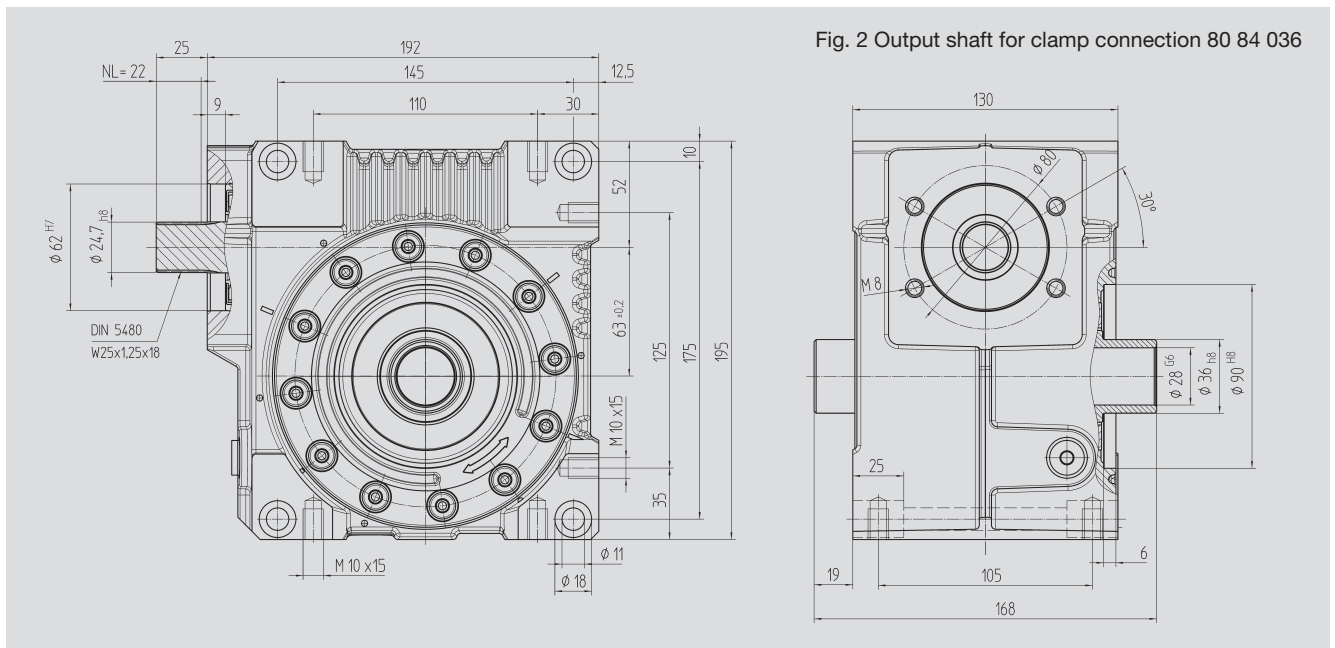

Center Distance

$$a_o = 63 \text{ mm}$$

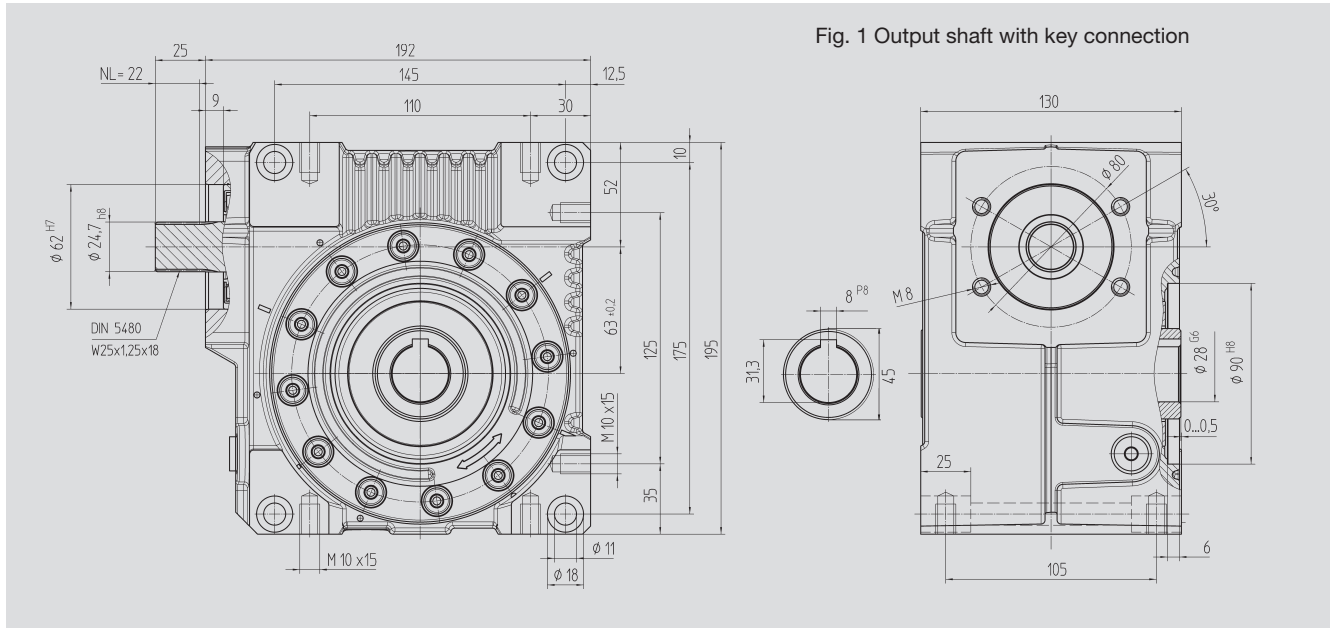

| Order Code Fig. 1 | Fig. 2 | Ratio i | kg | J _{red} 10 ⁻⁴ kg m ² |
|----------------------|-----------|---------|------|--|
| 58 04 005 | 58 14 005 | 4.75 | 11.5 | 2.5350 |
| 58 04 007 | 58 14 007 | 6.75 | 11.5 | 1.3720 |
| 58 04 009 | 58 14 009 | 9.25 | 11.5 | 0.9825 |
| 58 04 015 | 58 14 015 | 14.50 | 11.5 | 0.9590 |
| 58 04 020 | 58 14 020 | 19.50 | 11.5 | 0.6940 |
| 58 04 029 | 58 14 029 | 29.00 | 11.5 | 0.9966 |
| 58 04 039 | 58 14 039 | 39.00 | 11.5 | 1.0100 |
| 58 04 052 | 58 14 052 | 52.00 | 11.5 | 0.5305 |

With food grade oil, order code 58 04 1xx / 58 14 1xx

With ATEX version with food grade oil, order code 58 04 2xx / 58 14 2xx



Motor Flange

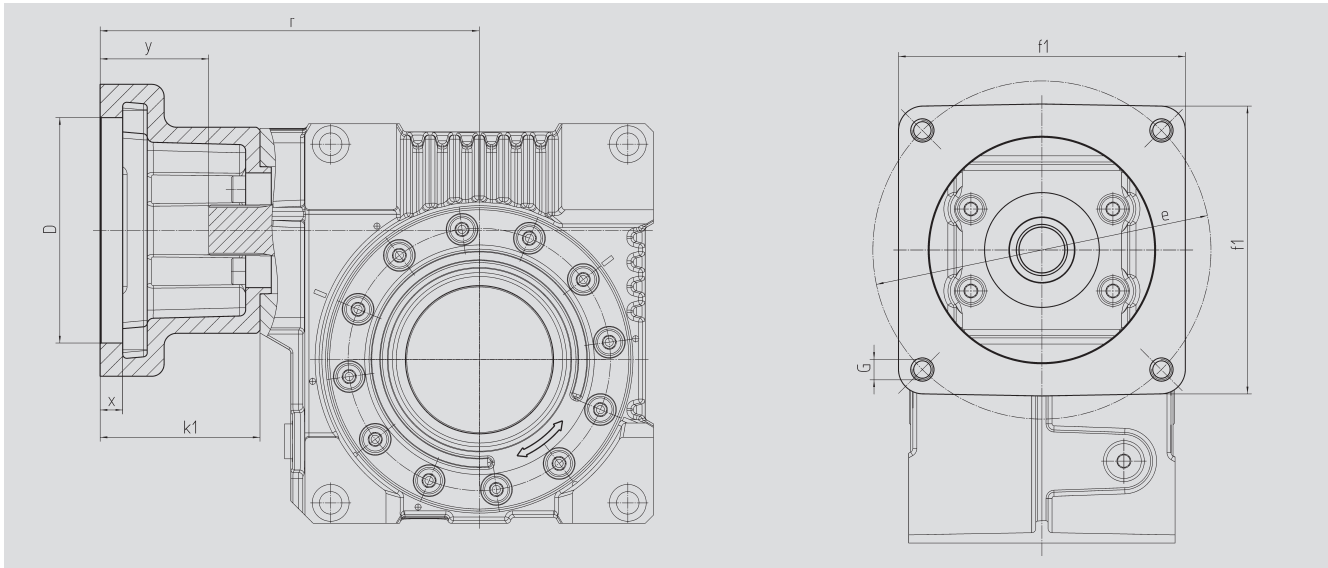

Center Distance

$a_o = 63 \text{ mm}$

| Order Code | D ^{G7} | k ₁ | r | x | y | f ₁ | e | G |  kg |
|------------|-----------------|----------------|-----|------|-----|----------------|-------------|------------|---|
| 65 59 301 | 95.0 | 62 | 169 | 12.5 | 37 | 100 | 115 | M8 | 0.60 |
| 65 59 302 | 50.0 | 62 | 169 | 10.0 | 37 | 100 | 70, 95, 115 | M4, M6, M8 | 0.70 |
| 65 59 303 | 80.0 | 62 | 169 | 10.0 | 37 | 100 | 100 | M6 | 0.65 |
| 65 59 304 | 95.0 | 78 | 185 | 10.0 | 53 | 115 | 130 | M8 | 0.80 |
| 65 59 305 | 95.0 | 72 | 179 | 8.0 | 47 | 100 | 115 | M8 | 0.75 |
| 65 59 306 | 60.0 | 74 | 181 | 21.0 | 49 | 100 | 75, 90, 115 | M5, M5, M8 | 0.90 |
| 65 59 307 | 70.0 | 70 | 177 | 21.0 | 45 | 100 | 90, 115 | M6, M8 | 0.80 |
| 65 59 401 | 95.0 | 73 | 180 | 8.0 | 48 | 100 | 115 | M8 | 0.75 |
| 65 59 402 | 110.0 | 78 | 185 | 8.0 | 53 | 115 | 130 | M8 | 0.80 |
| 65 59 403 | 95.0 | 73 | 180 | 12.0 | 48 | 115 | 130 | M8 | 0.75 |
| 65 59 404 | 110.0 | 73 | 180 | 12.0 | 48 | 115 | 130 | M8 | 0.70 |
| 65 59 405 | 95.0 | 78 | 185 | 11.0 | 53 | 140 | 165 | M10 | 1.20 |
| 65 59 406 | 110.0 | 78 | 185 | 11.0 | 53 | 140 | 165 | M10 | 1.15 |
| 65 59 407 | 130.0 | 78 | 185 | 11.0 | 53 | 140 | 165 | M10 | 1.00 |
| 65 59 409 | 130.0 | 98 | 205 | 14.0 | 73 | 140 | 165 | M10 | 1.10 |
| 65 59 410 | 110.0 | 74 | 181 | 8.0 | 49 | 120 | 145 | M8 | 1.00 |
| 65 59 411 | 110.0 | 84 | 191 | 8.0 | 59 | 120 | 145 | M8 | 1.20 |
| 65 59 412 | 114.3 | 105 | 212 | 8.0 | 80 | 180 | 200 | M12 | 3.70 |
| 65 59 413 | 114.3 | 139 | 246 | 8.0 | 114 | 180 | 200 | M12 | 3.35 |
| 65 59 414 | 114.3 | 91 | 198 | 8.0 | 66 | 180 | 200 | M12 | 2.65 |
| 65 59 415 | 110.0 | 89 | 196 | 8.0 | 64 | 120 | 145 | M8 | 1.30 |

The order should contain gear box 58 04 0xx / 58 14 0xx and flange 65 59 3xx or 4xx.